

# STOCKHOLM

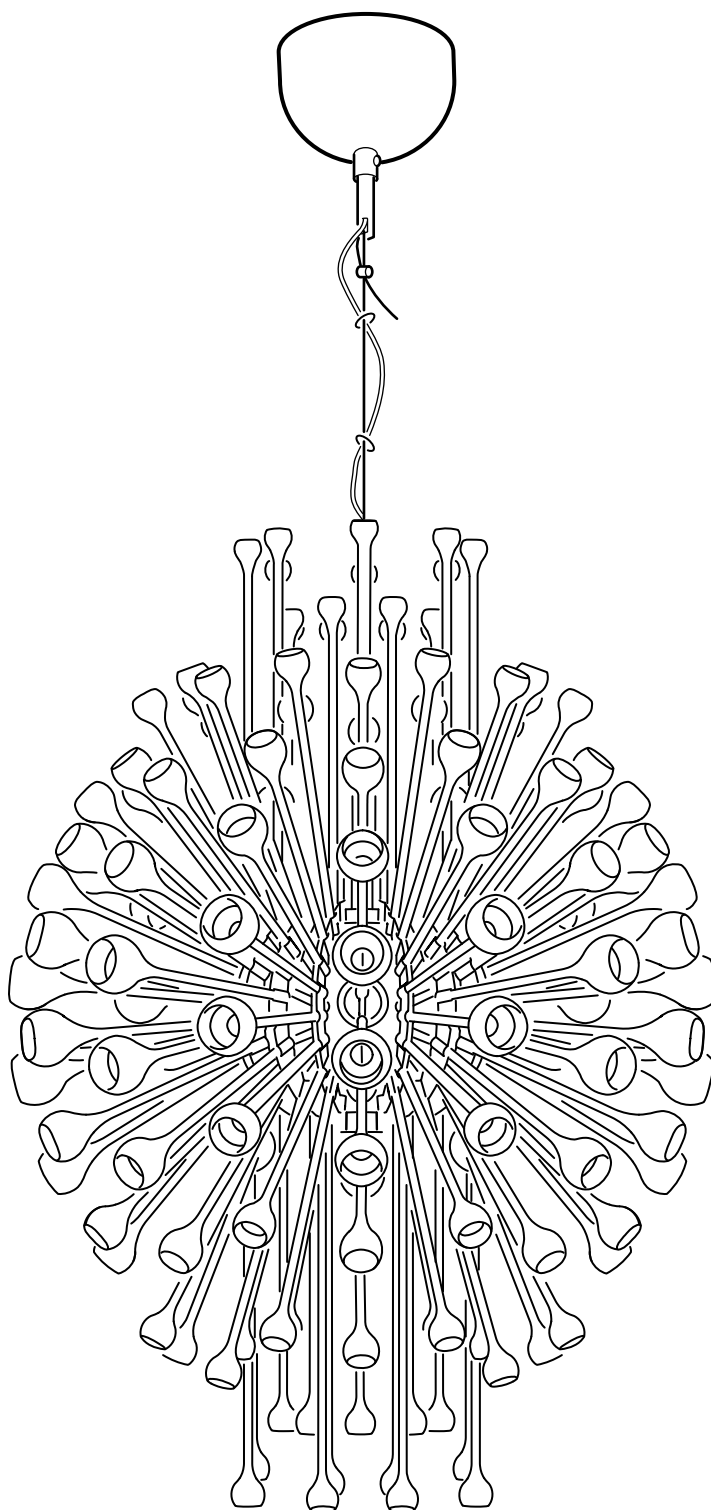

Design and Quality  
IKEA of Sweden



**ENGLISH**  
INSTALLATION INSTRUCTIONS

## CAUTION:

Before starting, turn off power at main circuit panel.

**FRANÇAIS**  
INSTRUCTIONS D'INSTALLATION

## ATTENTION:

coupez l'alimentation avant de procéder à l'installation.

**ESPAÑOL**  
INSTRUCCIONES DE MONTAJE

## ADVERTENCIA:

Antes de comenzar el montaje, cortar la luz en el cuadro general.

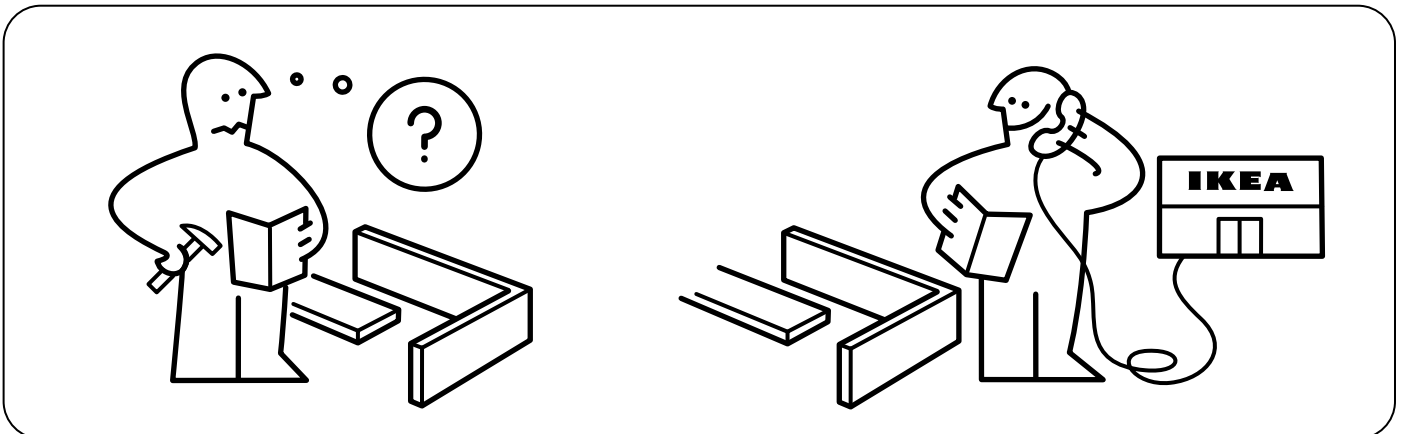
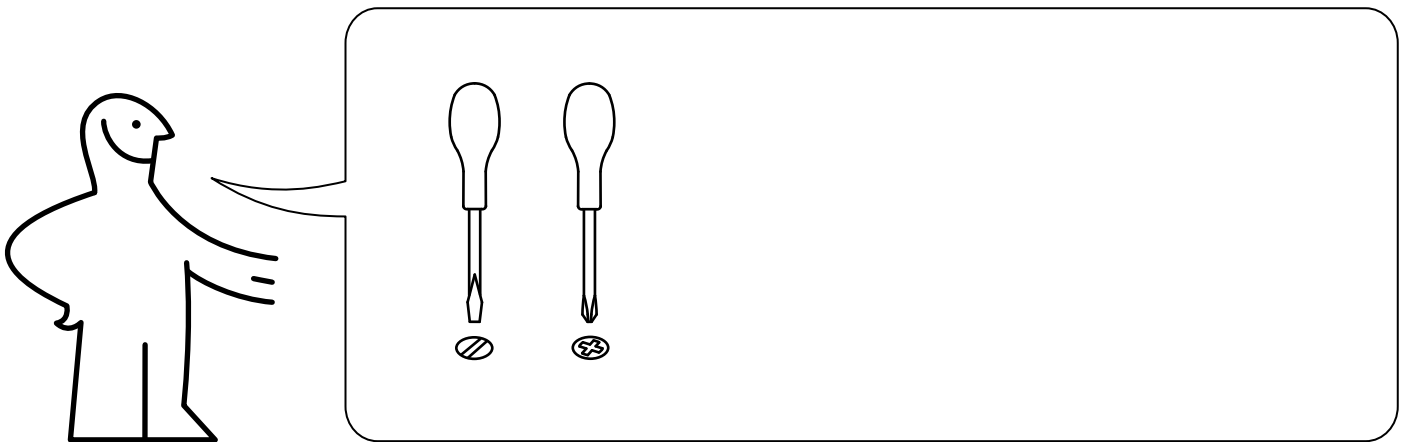

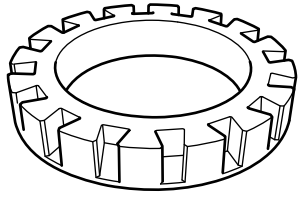

1x

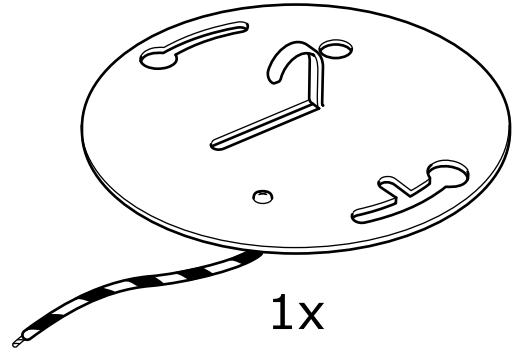

1x

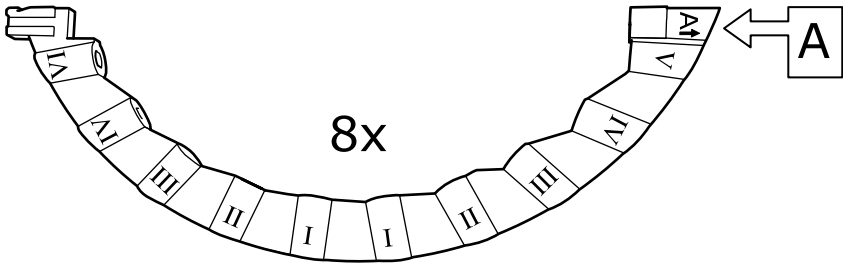

8x

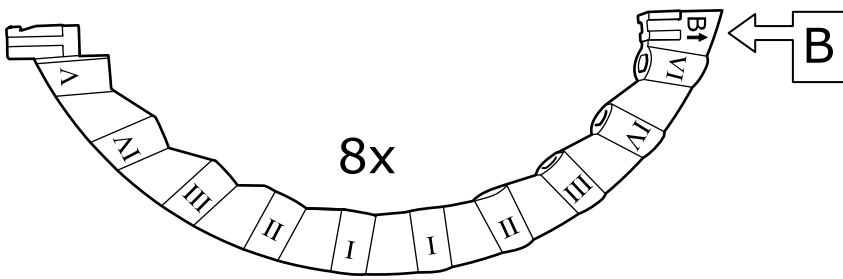

8x

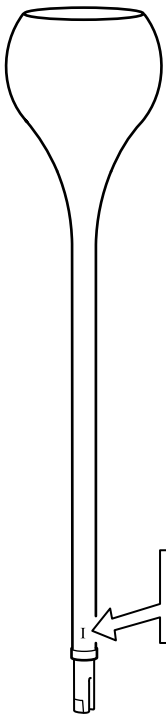

I

32x

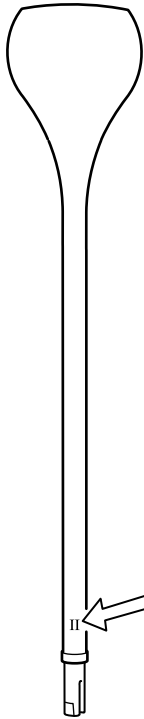

II

32x

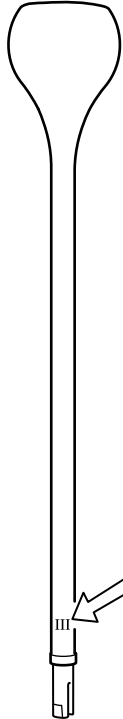

III

32x

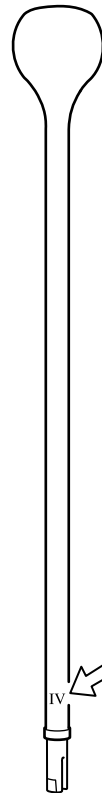

IV

32x

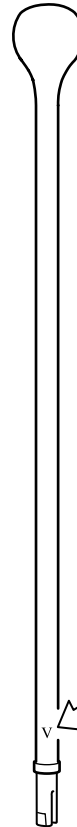

V

16x

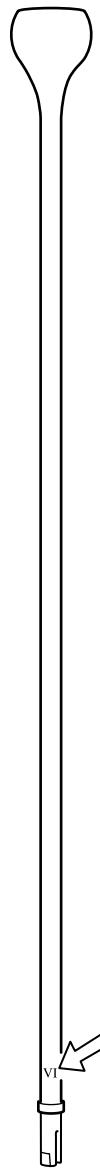

VI

16x

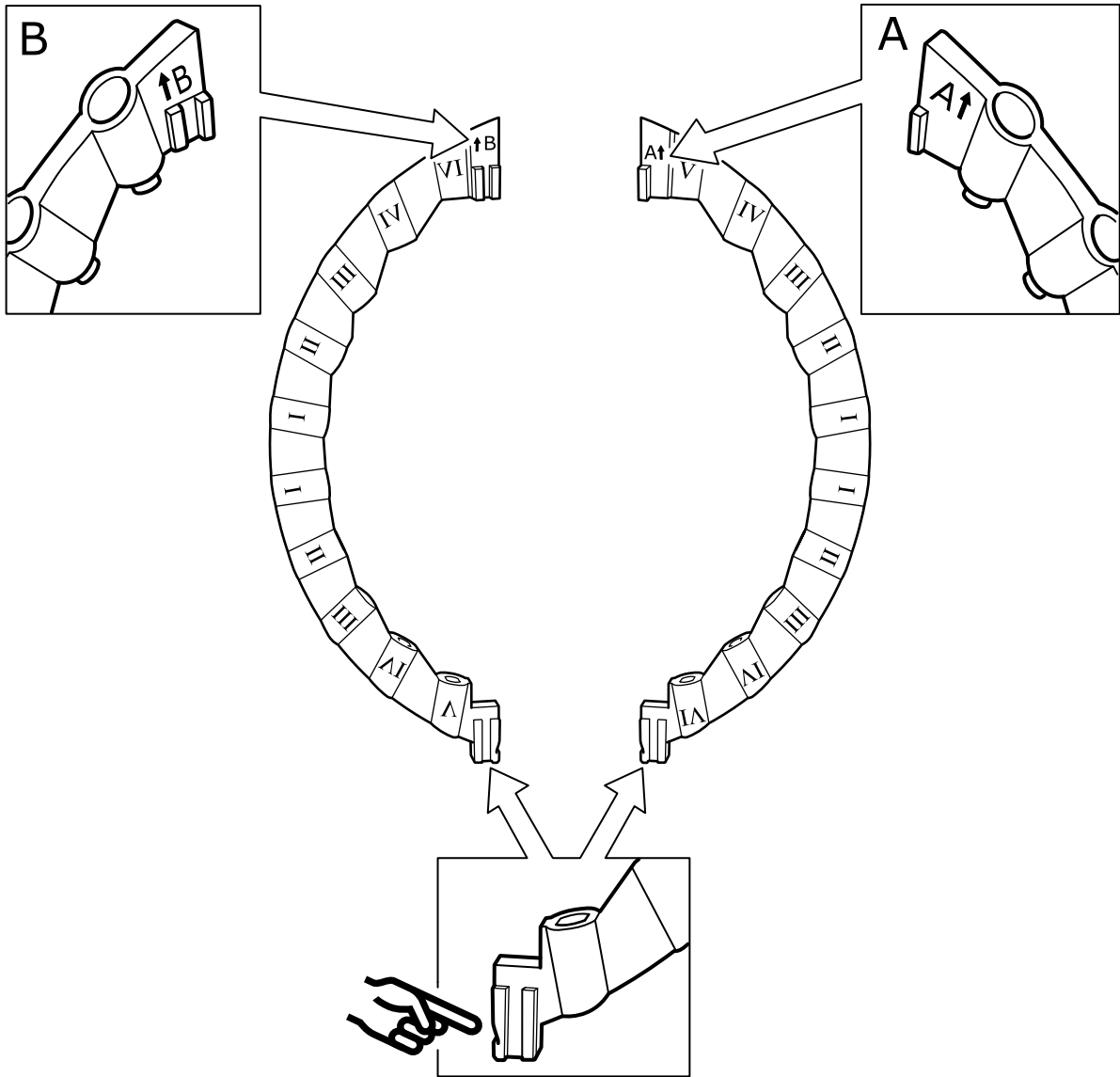

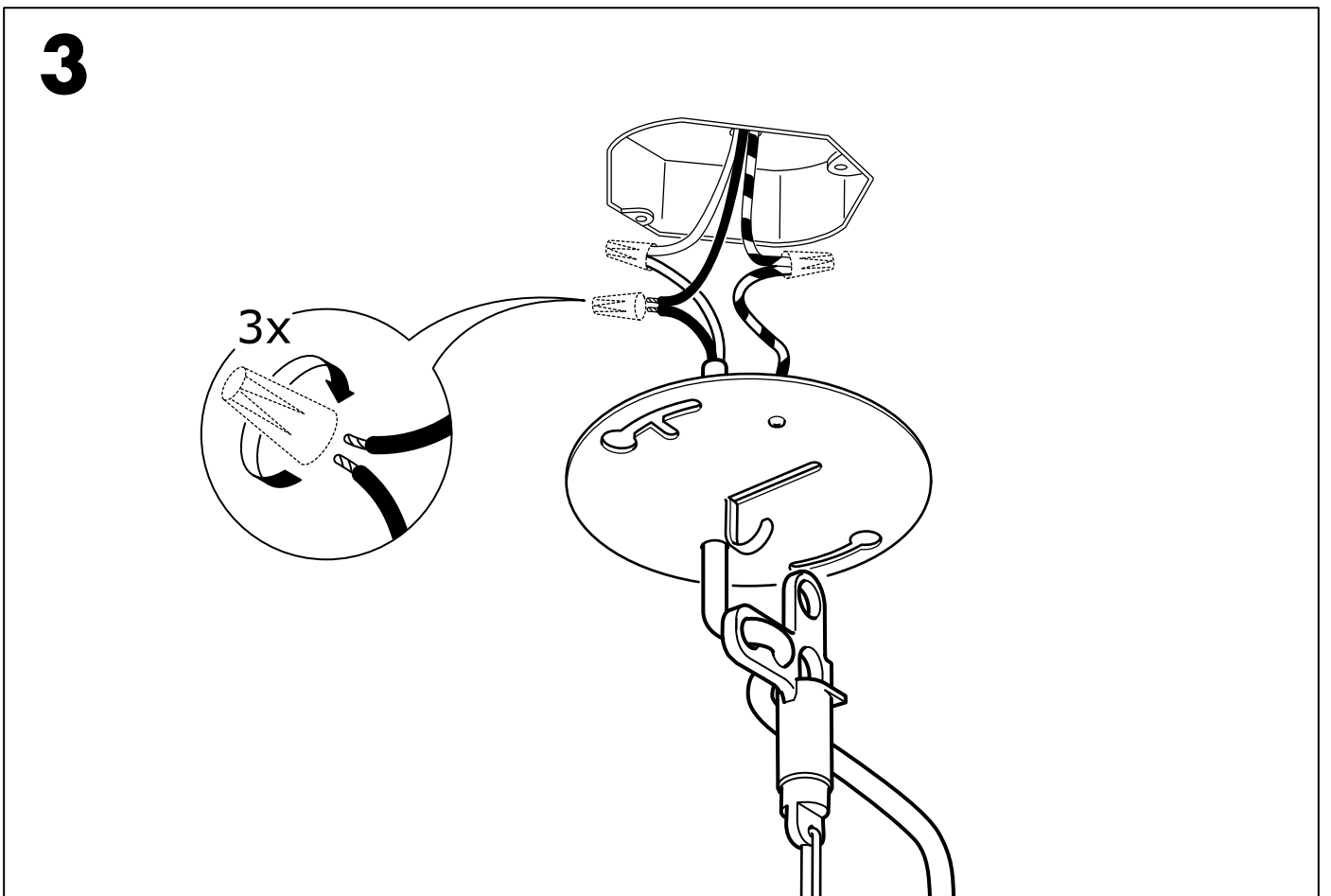
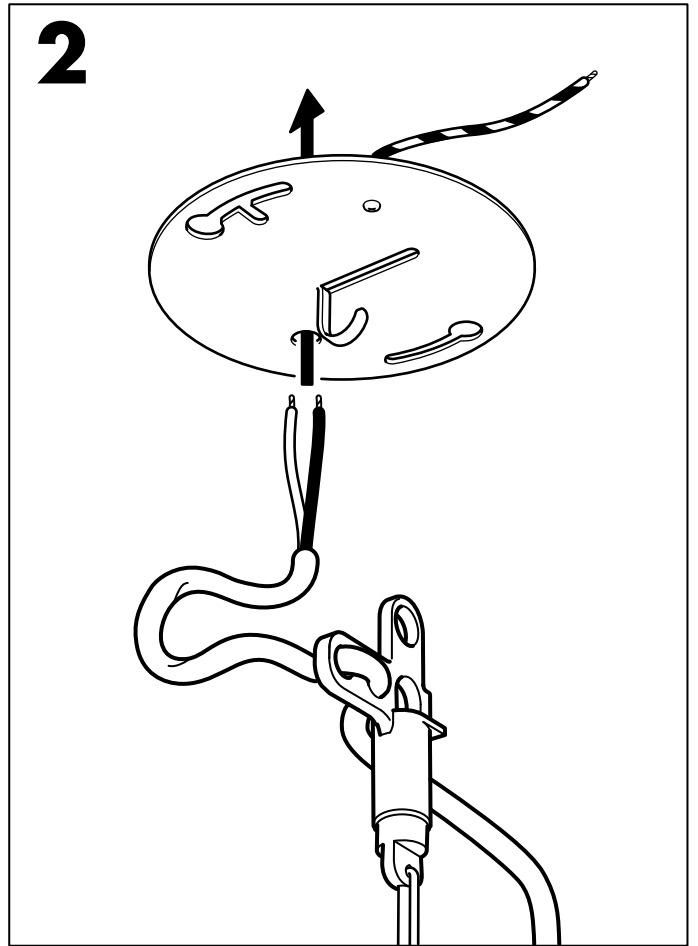
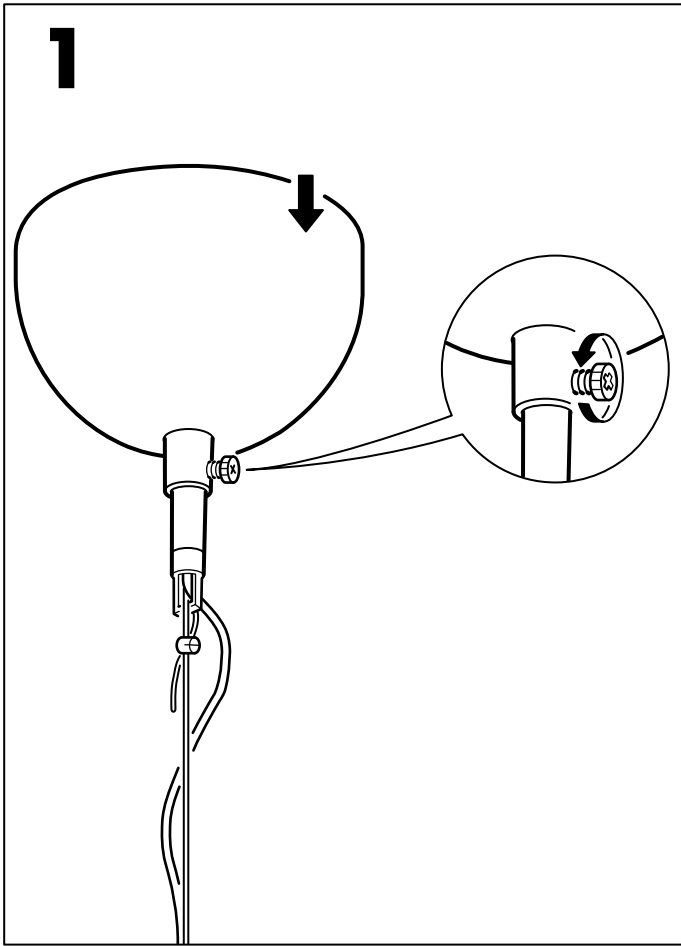

**4**

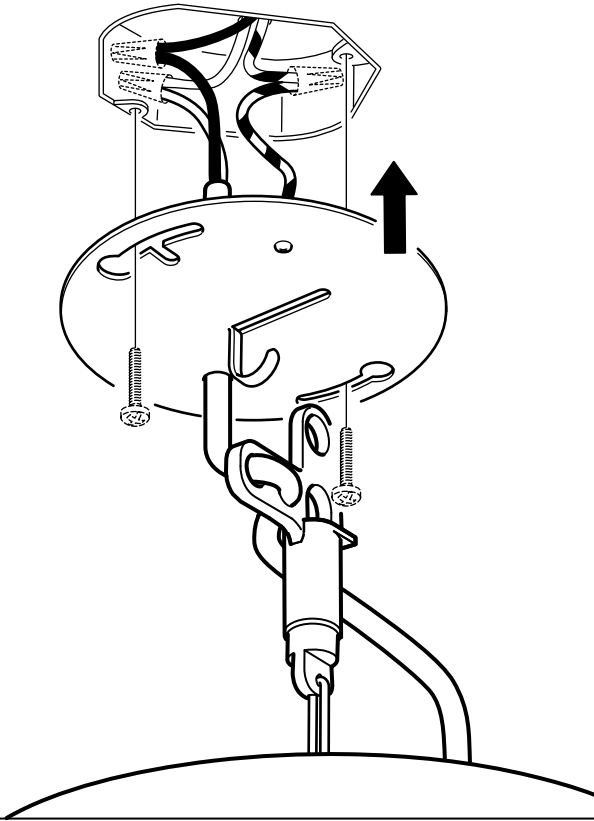

**5**

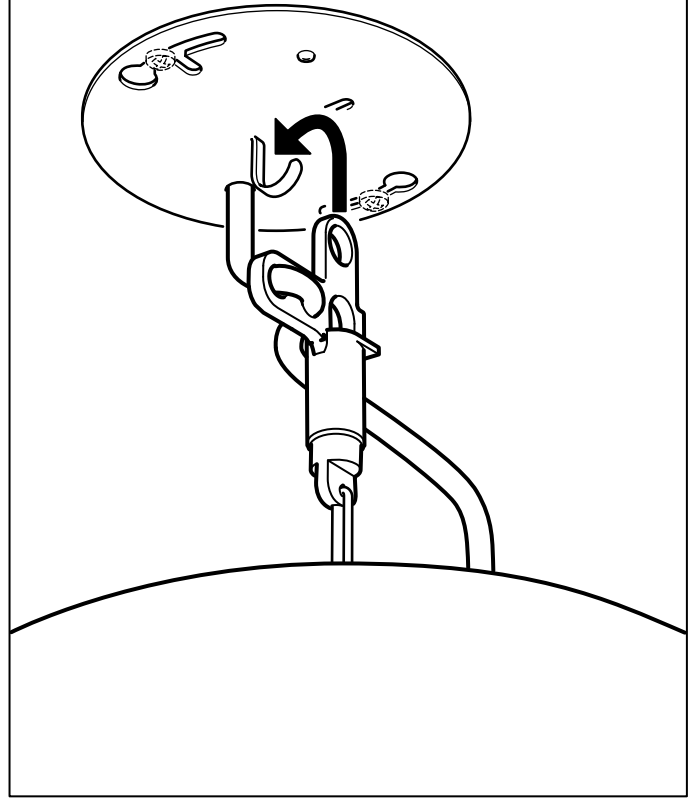

**6**

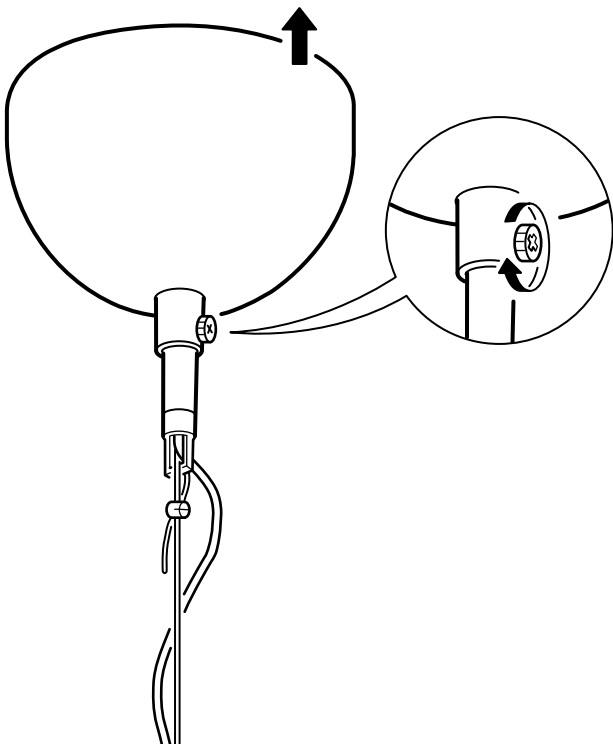

**7**

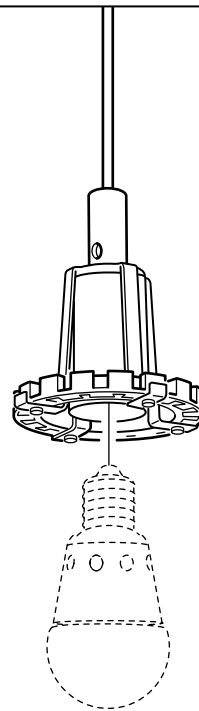

8

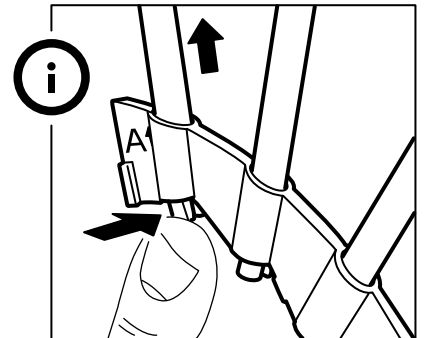
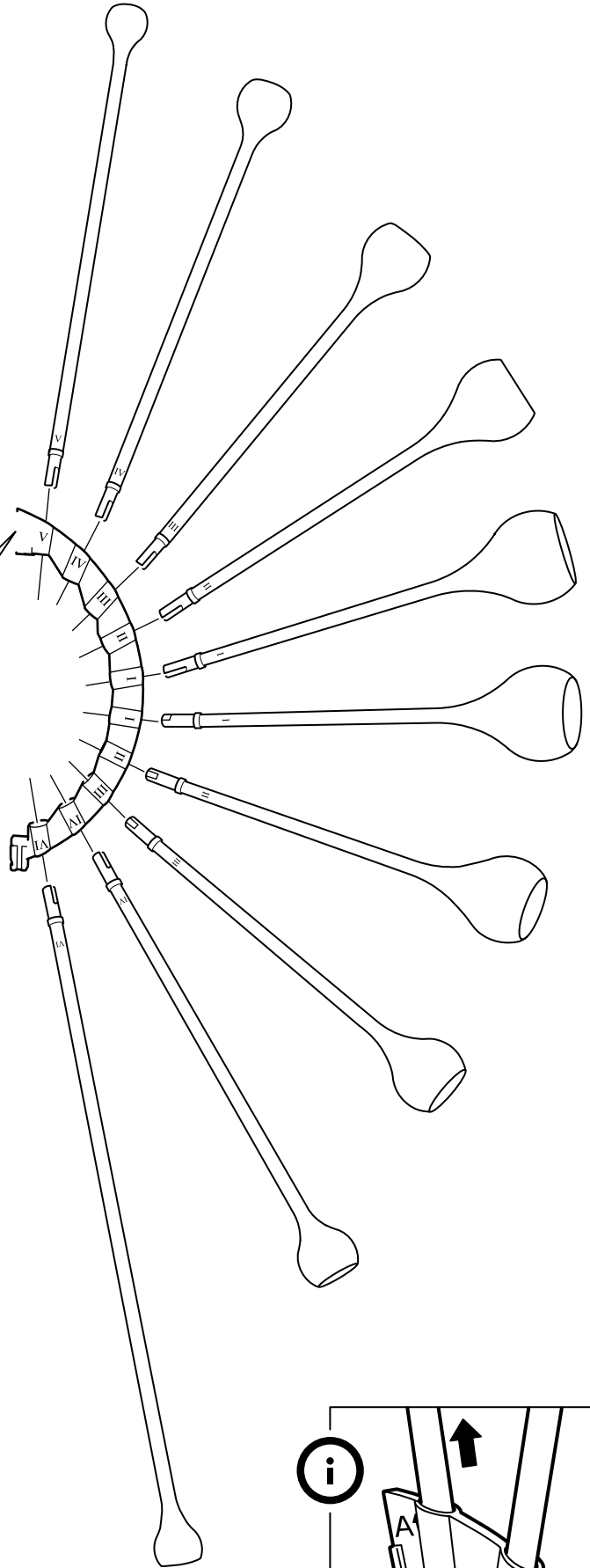
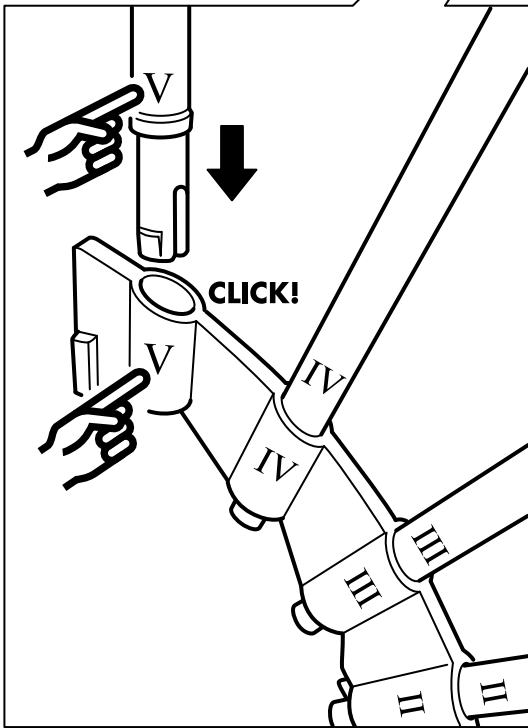
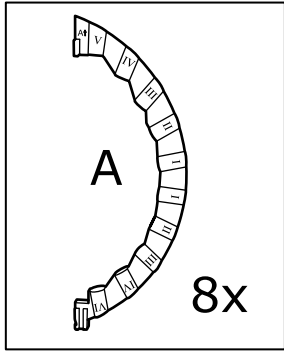

9

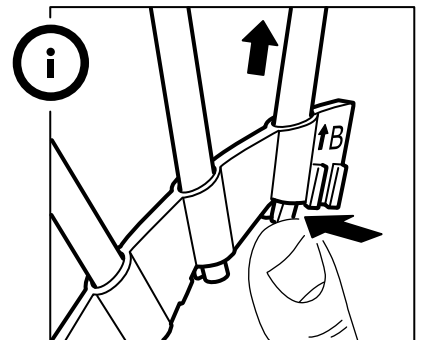
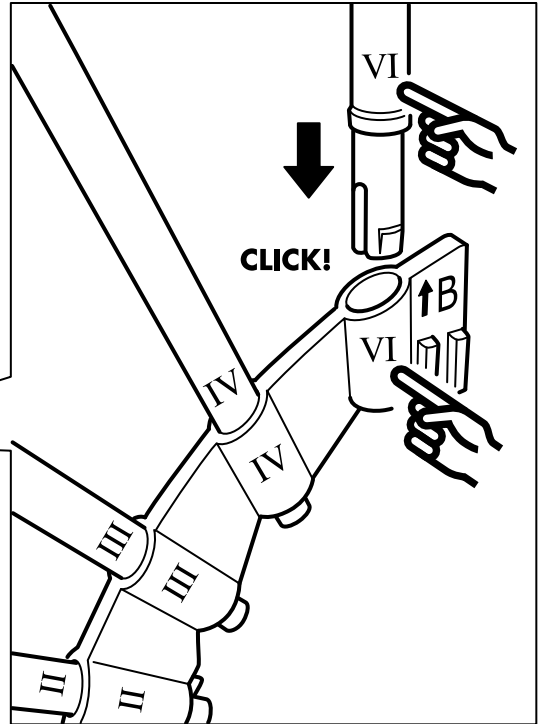
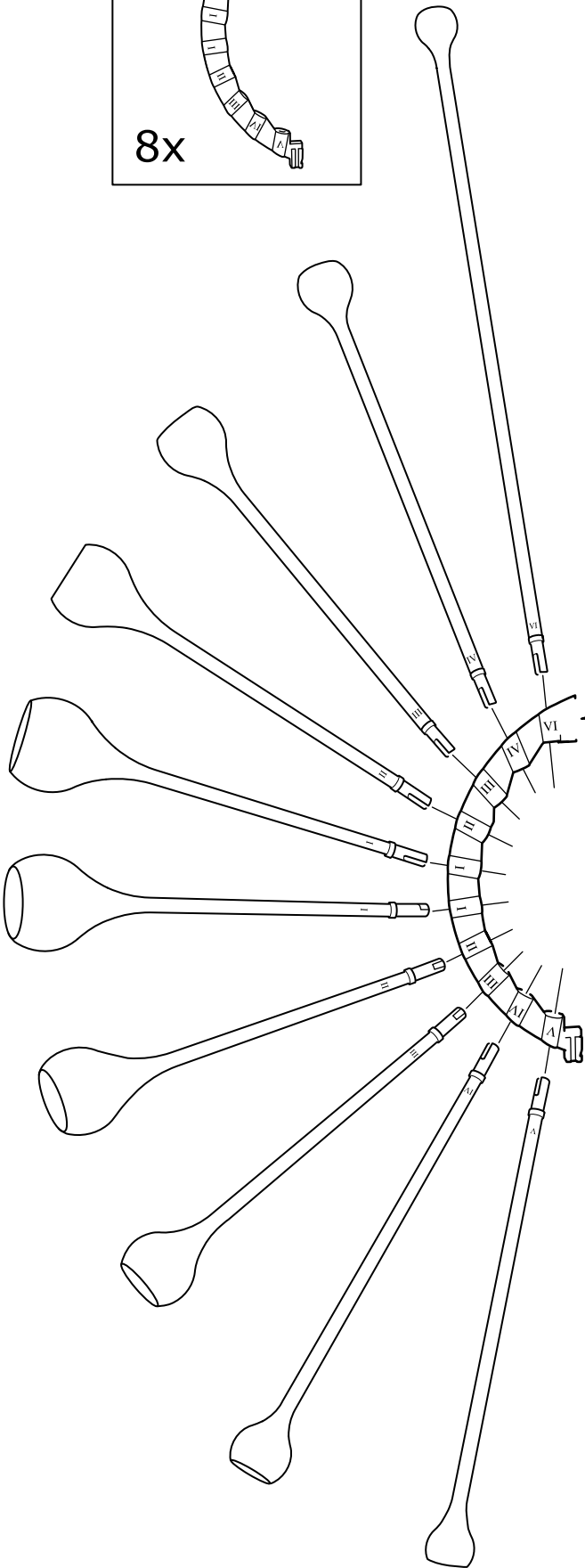
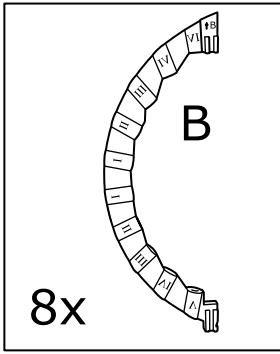



10

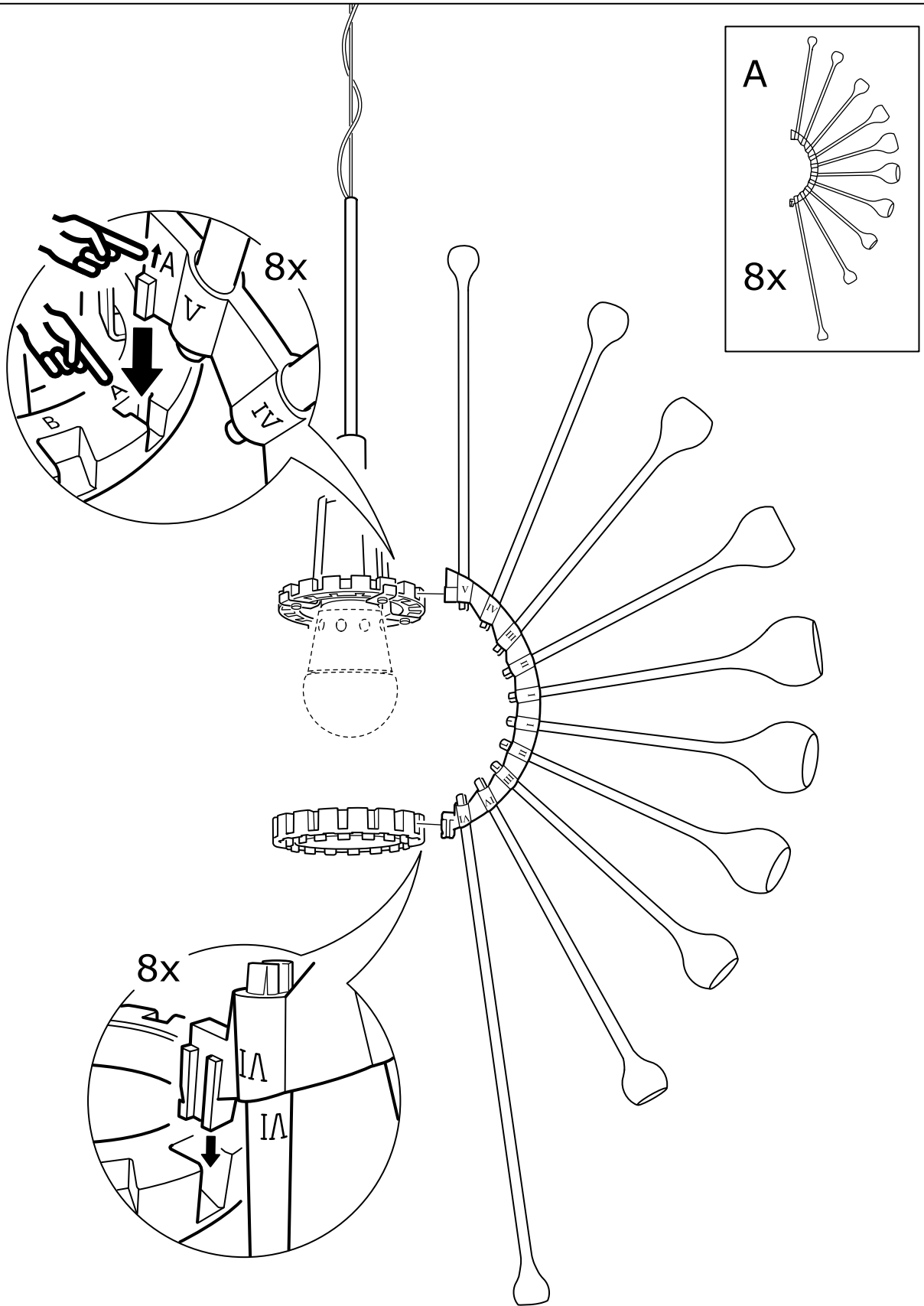

11

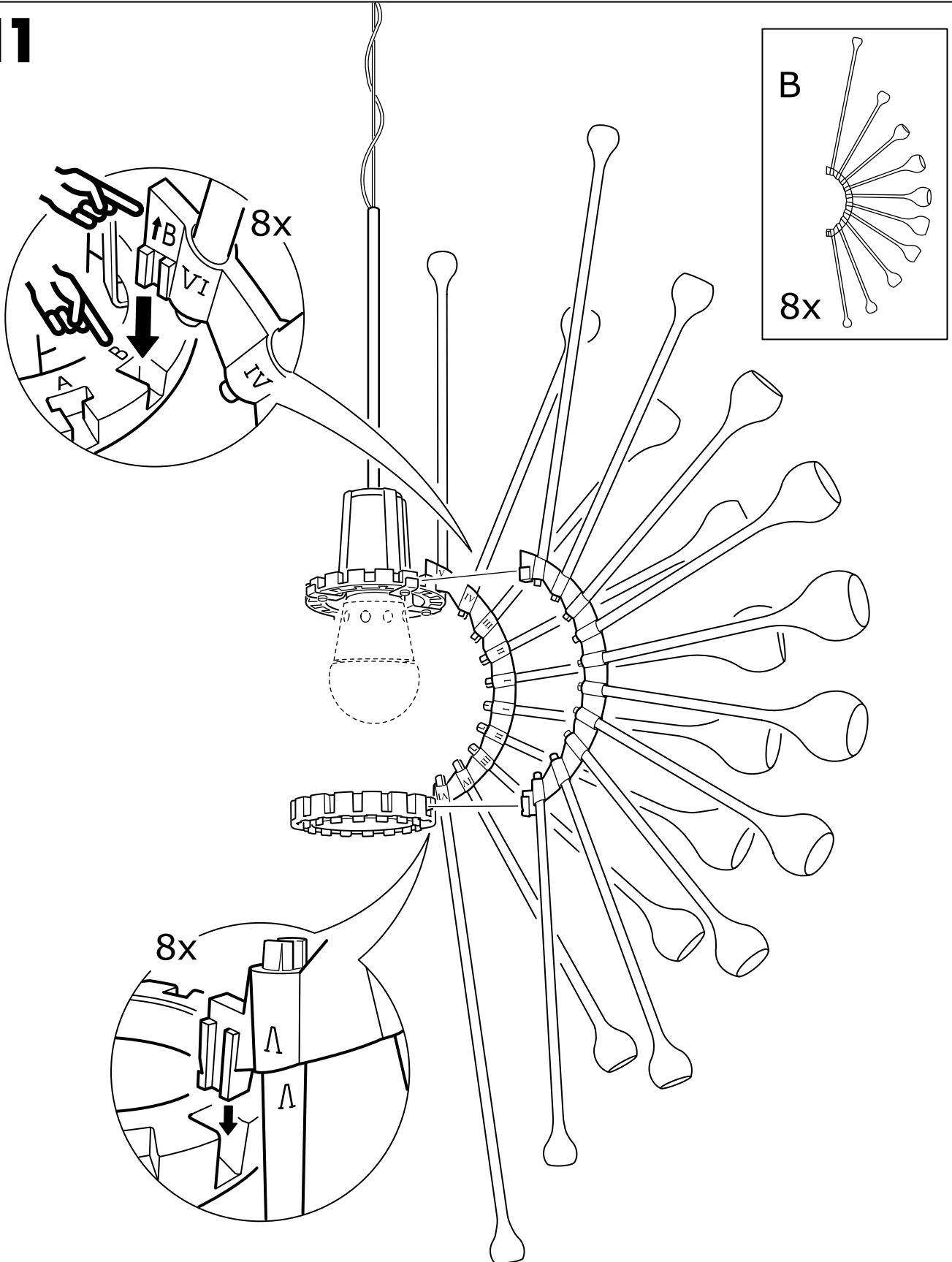

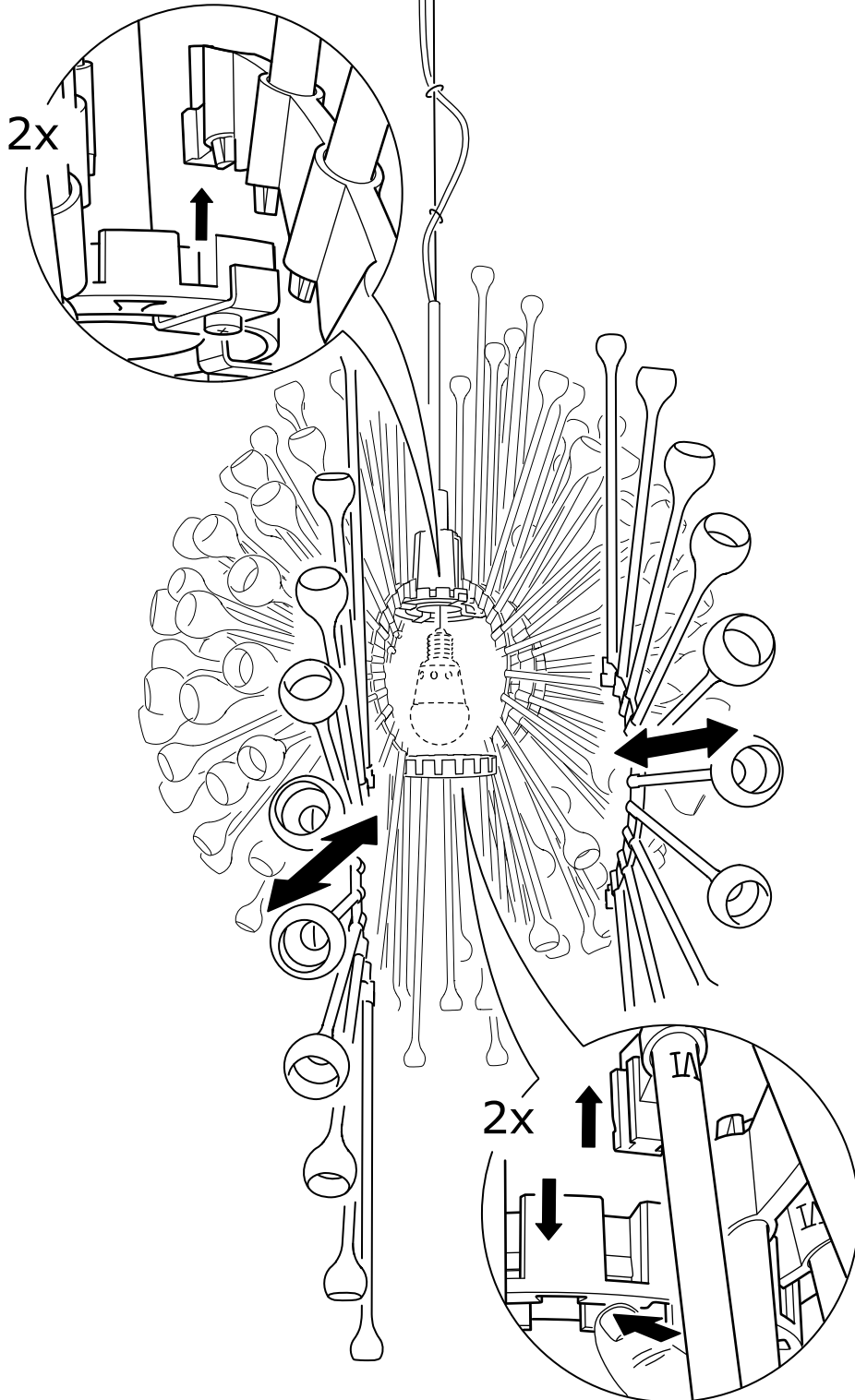

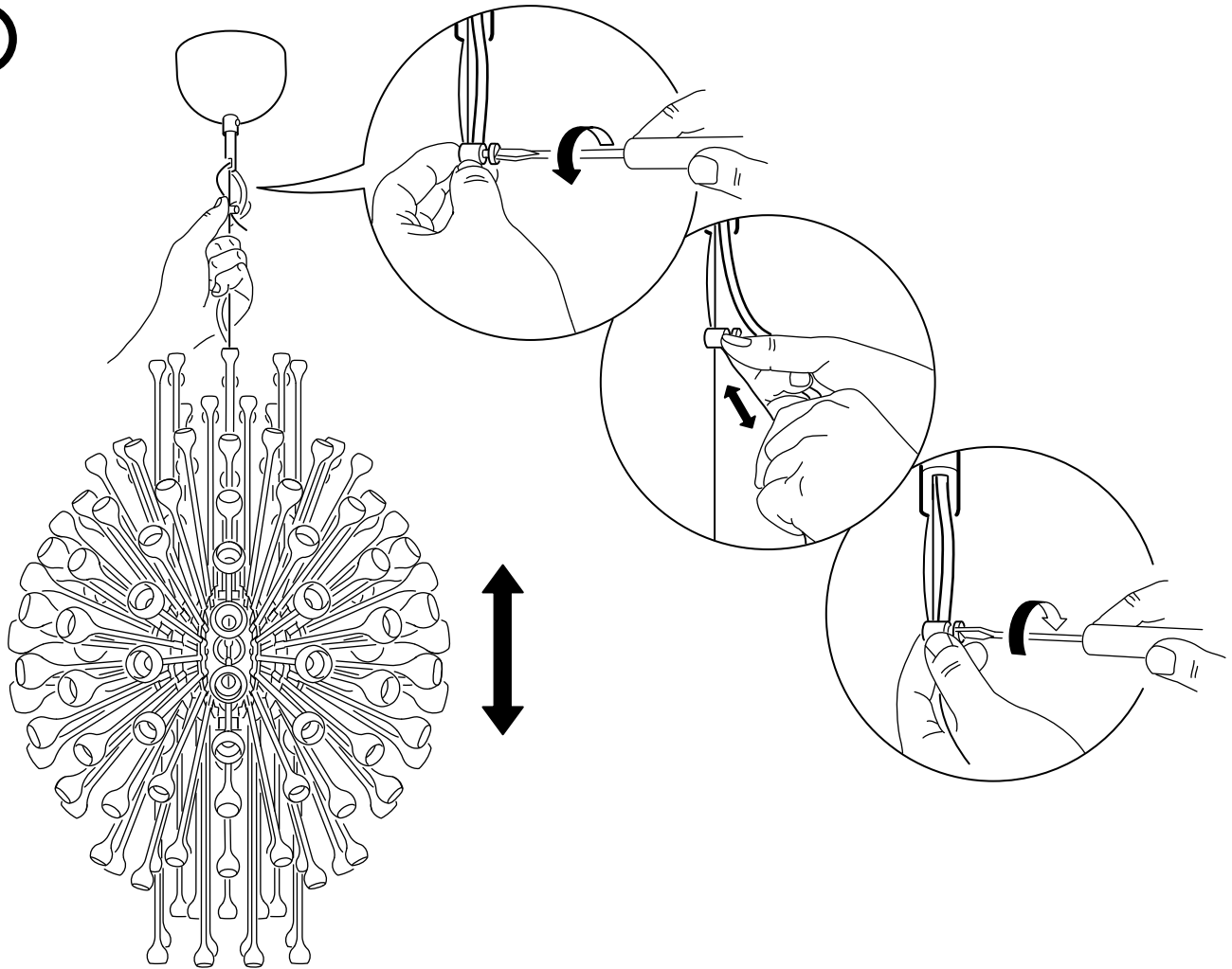

#### ENGLISH

The weight of the lamp must be taken by the suspension wire. When adjusting the cable make sure that it is longer than the wire.

#### FRANÇAIS

Le fil de suspension doit supporter le poids du luminaire. Lors de l'ajustement du câble, s'assurer que celui-ci est plus long que le fil de suspension.

#### ESPAÑOL

El hilo debe soportar el peso de la lámpara. Al ajustar el cable, comprueba que sea más largo que el hilo.

