

# TRÅDFRI

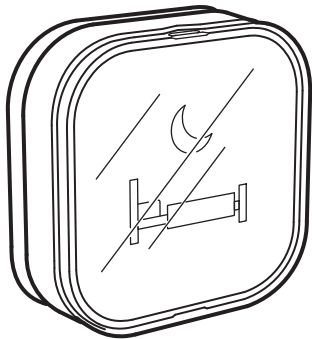

Design and Quality  
IKEA of Sweden



### **English**

Different materials require different types of fittings. Always choose screws and plugs that are specially suited to the material.

### **Français**

Le choix des vis dépend du matériau dans lequel elles doivent être fixées. Utiliser des vis et chevilles adaptées au matériau du support.

### **Español**

Diferentes materiales requieren diferentes clases de herrajes. Recuerda que los tornillos y tacos que elijas se deben adaptar al material en el que irán sujetos.

## **MX**

Importador/Distribuidor: IKEA Supply Mexico, S.A. de C.V., Av. Paseo de las Palmas 275, Int. 403-404, Lomas de Chapultepec V sección, Miguel Hidalgo C.P.: 11000 Ciudad de México, México, Tel. 800-1-4532 69.

Lea y siga todas las instrucciones de seguridad y operación antes de usar este producto/Para uso Interior/Consulte Especificaciones eléctricas en el etiquetado del producto.

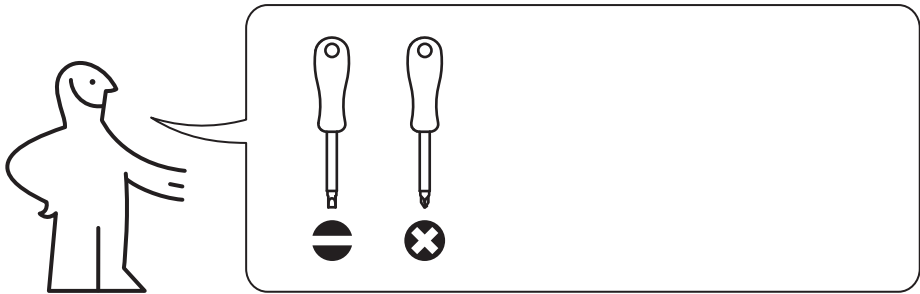

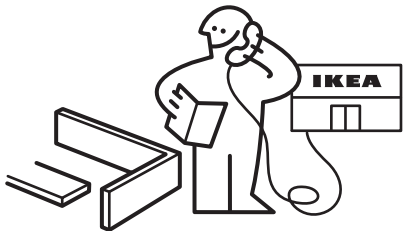
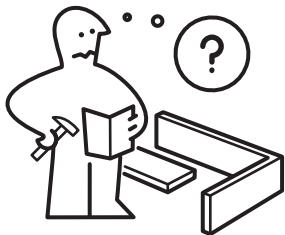

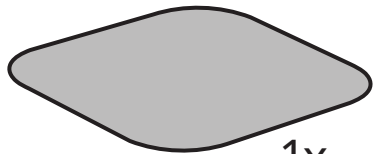

1x

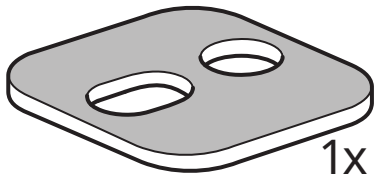

1x

190011

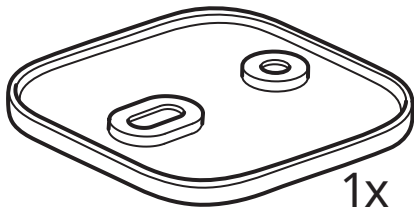

1x

190013

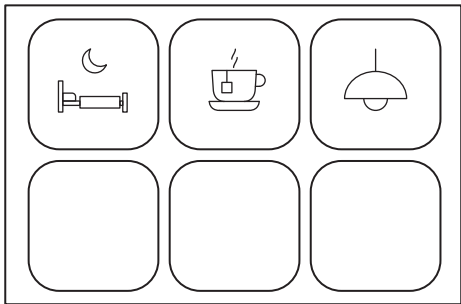

1x



1x

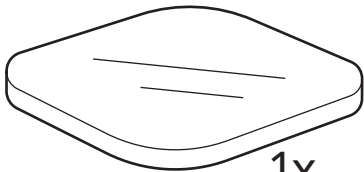

1x

1

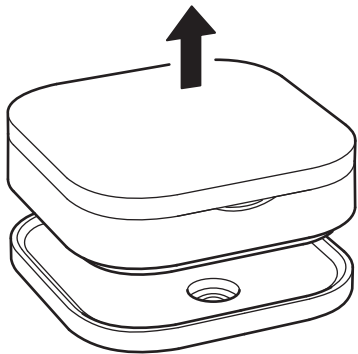



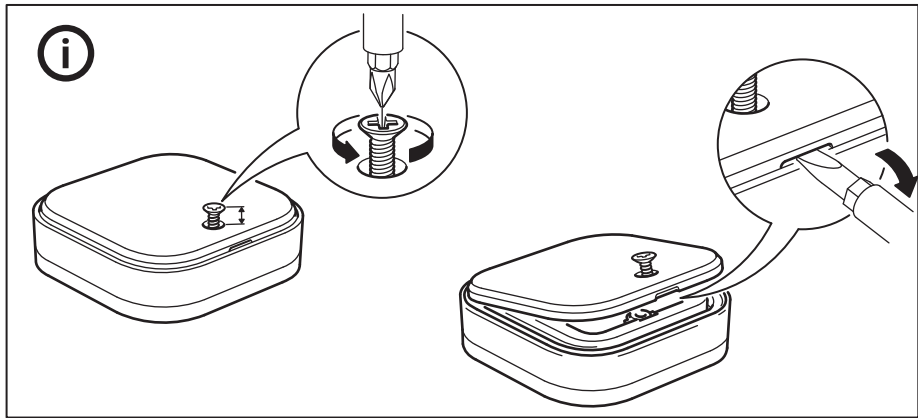



Click!

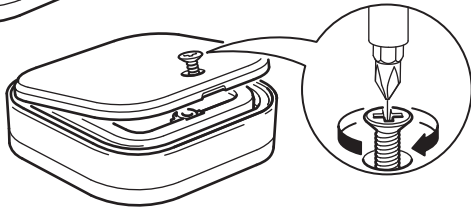

2

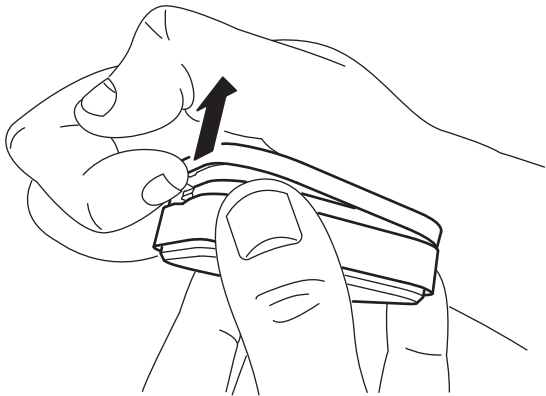

3

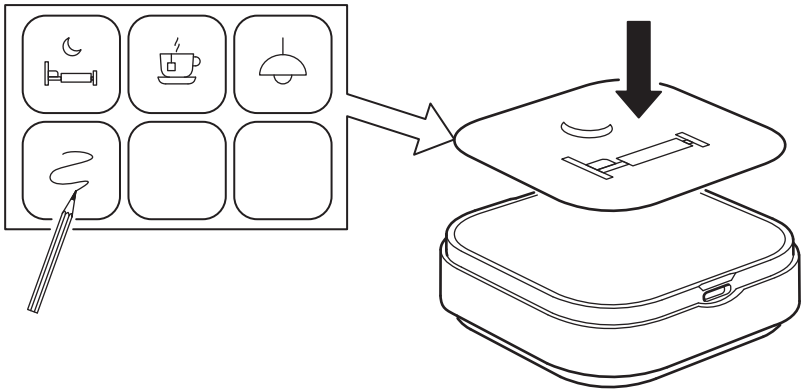

4

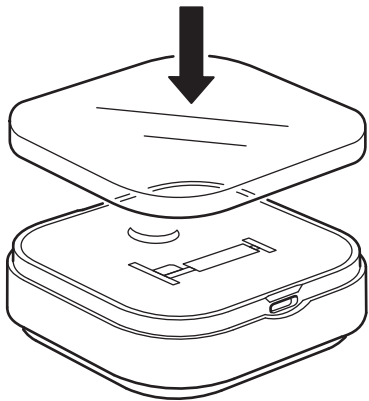



### **English**

Keep battery out of children's reach.  
To swallow a battery could be fatal. If  
this happens seek medical attention at  
once. Before disposal always cover the  
battery in plastic tape to avoid possible  
short circuit.

**SAVE THESE INSTRUCTIONS.**

### **Français**

Gardez la pile hors de portée des  
enfants. Avaler une pile peut être  
fatal. Si cela se produit, appelez  
immédiatement un médecin. Avant  
de mettre la pile au rebut, couvrez-la  
d'une bande plastique pour éviter tout  
court-circuit.

**CONSERVER CES INSTRUCTIONS**



## **Español**

Mantén la pila fuera del alcance de los niños. Ingerir una pila podría ser fatal. En caso de que suceda, acude inmediatamente al médico. Antes de desecharla cubre la pila con plástico para evitar cortocircuitos.

**GUARDA ESTAS INSTRUCCIONES.**

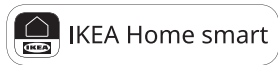
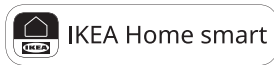
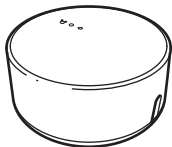



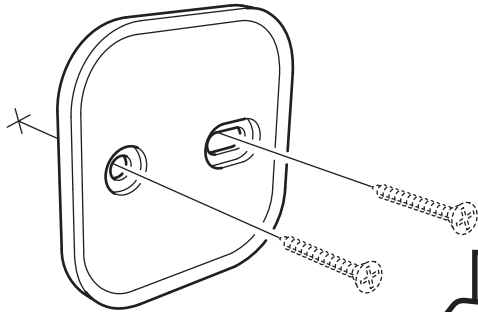
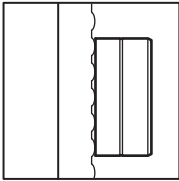
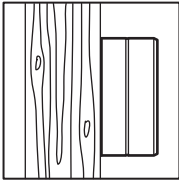



5

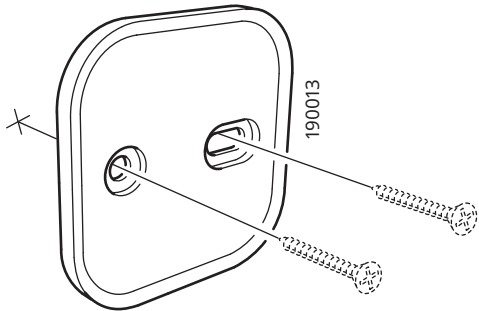
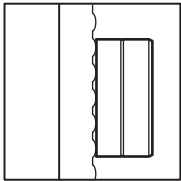
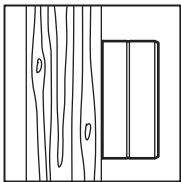

6

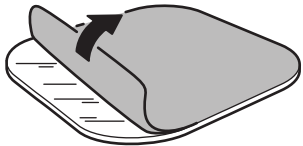

7

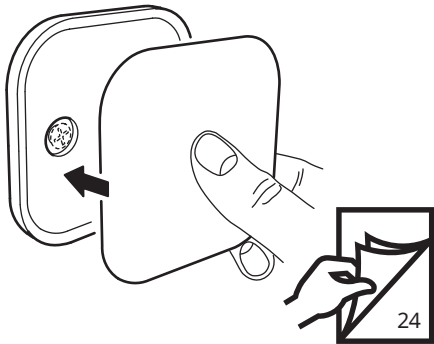

5

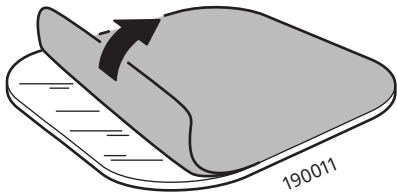
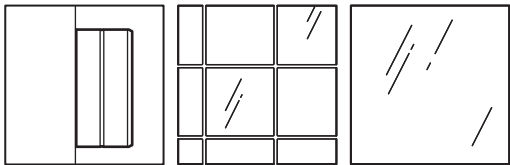

6

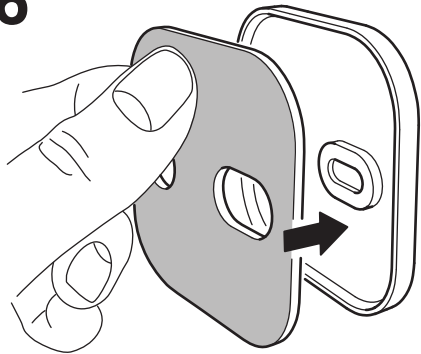

7

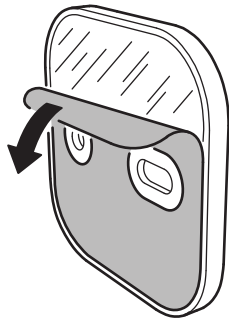

8

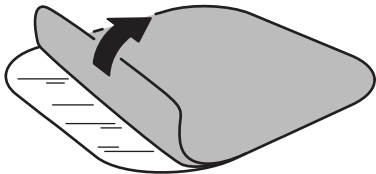

9

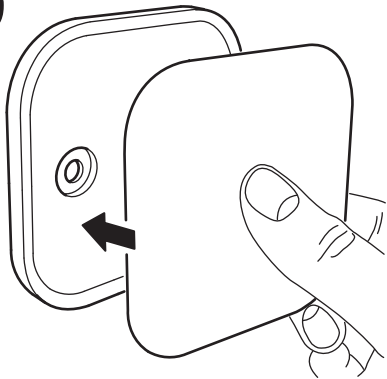

**10**

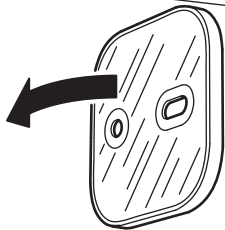

24

**11**

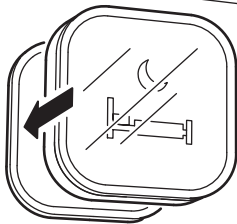

AA-2189468-5



